

LEGEND

- INTERSTATE HIGHWAY
- STATE HIGHWAY
- COUNTY ROAD; PRIMARY SYSTEM (PAVED)
- COUNTY ROAD; LOCAL SYSTEM (PAVED)
- COUNTY ROAD; LOCAL SYSTEM (UNPAVED)
- PRIVATE ROAD
- PUBLIC ROAD (NOT OPEN)
- ADJACENT COUNTY ROAD
- RAILROADS

ROAD PROJECTS

- 2011 SEAL COAT
- 2012 SEAL COAT
- 2013 SEAL COAT
- 2014 SEAL COAT
- 2015 SEAL COAT
- 2016 SEAL COAT
- 2017 SEAL COAT
- 2018 SEAL COAT
- 2019 SEAL COAT
- 2020 SEAL COAT
- 2021 SEAL COAT
- OTHER PROJECT

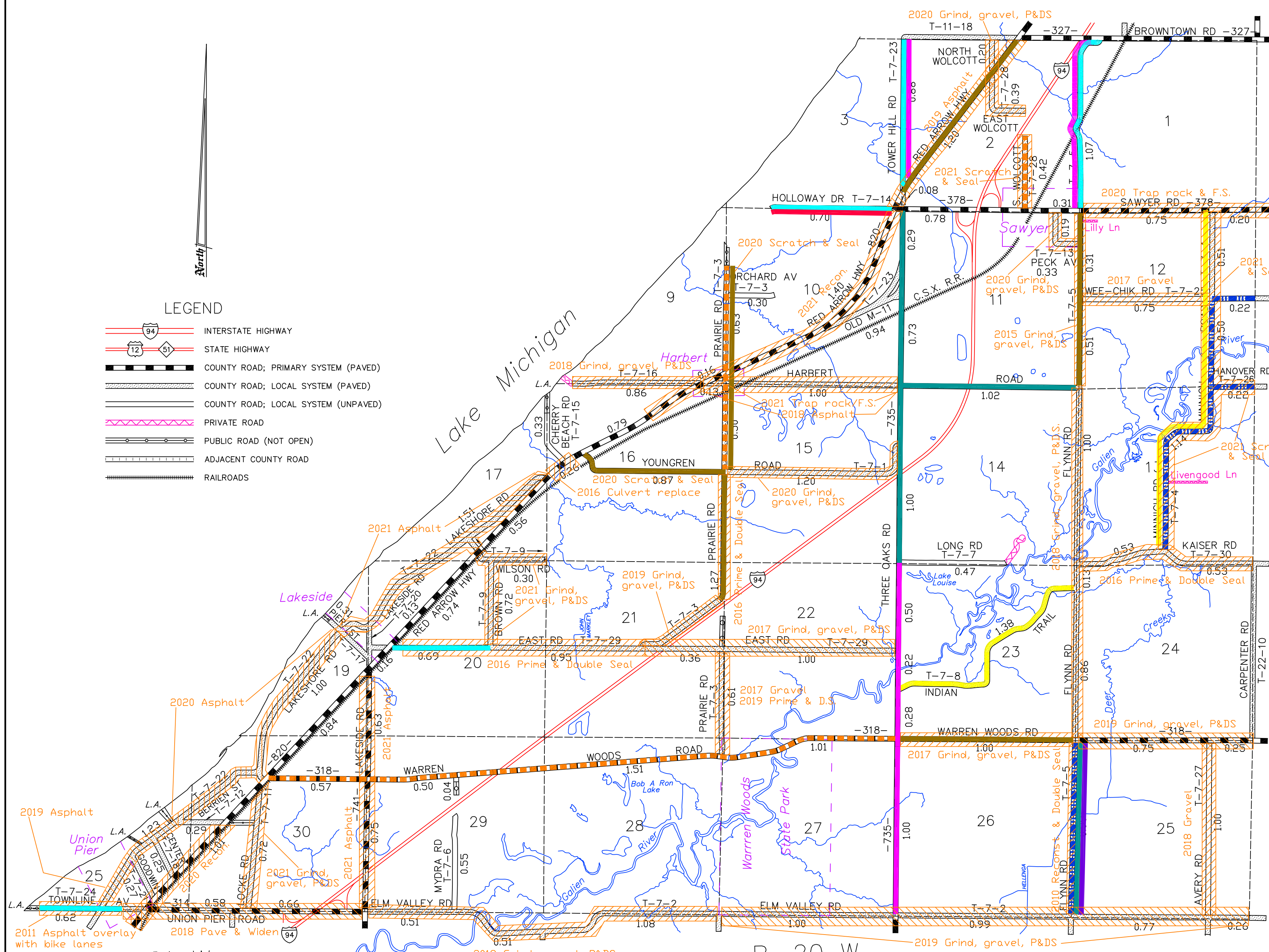

PRIMARY ROAD SYSTEM IS 21.39 MILES
 LOCAL ROAD SYSTEM IS 41.03 MILES

CHIKAMING TOWNSHIP

BERRIEN COUNTY
 ROAD DEPARTMENT
 BENTON HARBOR, MICHIGAN
 KEVIN STACK, COUNTY HWY ENGINEER
 SCALE: 1"=2000' DATE: October, 2021
 No. 7